



Standard Style



Lipped (with Collar)

Product Information

- Internally threaded expansion anchor for use in concrete

Key Features

- **Quick hammer** - set installation
- **Two versions** - Standard or Lipped (with Collar)
- **Zinc plated and passivated** - (3-5 microns)
- **Lipped (with Collar)** - Prevents the anchor being pushed too far into the concrete during installation
- **Setting tools** - To suit each size of anchor

Materials



Concrete

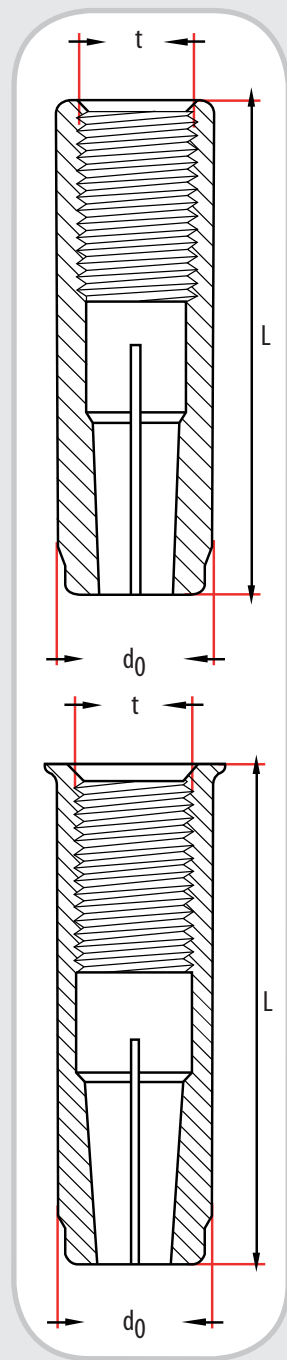

L - Length
d₀ - Drill Size
t - Thread Ø

Technical Data

Substrate	Concrete ≥ 25 N/mm ²				
	M6	M8	M10 (1030)	M10	M12
Size Ø (mm) t					
Drill Hole Ø (mm) d ₀	8	10	12	12	16
Embedment Depth (mm) h _{ef}	25	30	30	40	50
Min Drill Hole Depth (mm) h ₀	25	30	30	40	50
Centre Spacing (mm) s _{min}	75	90	90	120	150
Edge Distance (mm) c _{min}	75	90	90	120	150
Min Structure Thickness (mm)	100	100	100	100	125
Rec. Tightening Torque (Nm)	3	5	7	7	16
Rec. Tensile Load (kN) N _{rec}	1.29	2.22	3.16	4.65	9.35



Drop In Anchors - Standard Style

TIMco Code	Thread \emptyset t	Anchor Length (mm) L	Min Thread Length (mm)	Min Hole Depth (mm) h ₀	Clearance Hole in Fixture (mm) d _f	Box Qty	Carton Qty
06WA	M6	25	10	25	8	100	2,000
08WA	M8	30	14	30	10	100	1,200
10WA	M10	40	15	40	12	50	600
12WA	M12	50	20	50	14	50	300

Drop In Anchors - Lipped

TIMco Code	Thread \emptyset t	Anchor Length (mm) L	Min Thread Length (mm)	Min Hole Depth (mm) h ₀	Clearance Hole in Fixture (mm) d _f	Box Qty	Carton Qty
08LWA	M8	30	14	30	10	100	1,200
1030LWA	M10	30	15	30	12	50	600
10LWA	M10	40	15	40	12	50	600



Setting Tool

TIMco Code	To Fit Anchor Size	Qty Per Bag
06WAS	M6	1
08WAS	M8	1
10WAS	M10	1
12WAS	M12	1

Installation Guide



1) Drill a hole to the required diameter and depth

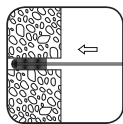

2) Clean the hole

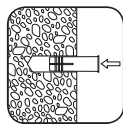

3) Place the anchor into the hole

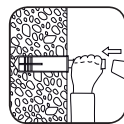

4) Using the matching setting tool and a club hammer, drive the cone into place until the collar of the setting tool rests against the surface of the anchor

5) Screw either a threaded rod or bolt into the anchor, to the minimum thread insertion depth

Applications

