

Stainless Steel Fasteners

SUPERIOR CORROSION RESISTANCE

A2 Stainless steel offers an excellent resistance to corrosion which makes it perfect for many day to day external and corrosive applications.



SUSTAINABLE STAINLESS STEEL

Stainless steel is regarded as one of the most sustainable metals on the planet.

Stainless Steel Carriage Bolts

SUPERIOR CORROSION RESISTANCE



Carriage Bolt (DIN603)

A2 Austenitic Stainless Steel

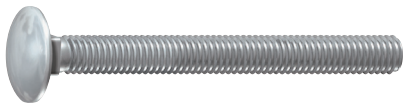

A cup square carriage bolt in A2 stainless steel. A full metric fine thread.
Nut not included.

Product Code	Size (mm)	Pack Qty (pcs)	Carton Qty (packs)	Pallet Qty (packs)
BOX				
0625CBSS	M6 x 25	200	8	288
0630CBSS	M6 x 30	200	8	288
0650CBSS	M6 x 50	200	5	180
06100CBSS	M6 x 100	50	10	360
0875CBSS	M8 x 75	50	8	288
0880CBSS	M8 x 80	50	8	288
08130CBSS	M8 x 130	25	6	216
08150CBSS	M8 x 150	25	6	216
1075CBSS	M10 x 75	50	6	216
10110CBSS	M10 x 110	25	10	360
10120CBSS	M10 x 120	25	8	288
1275CBSS	M12 x 75	50	5	180
12100CBSS	M12 x 100	50	3	108
12110CBSS	M12 x 110	25	6	216

TYPE - CAS

SUB TYPE - CAS01

Carriage Bolt (DIN603)

A2 Austenitic Stainless Steel

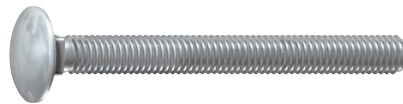

A cup square carriage bolt in A2 stainless steel. A full metric fine thread.
Nut not included.

Product Code	Size (mm)	Pack Qty (pcs)	Carton Qty (packs)
SMALL BAG			
0625CBSSX	M6 x 25	10	200
0630CBSSX	M6 x 30	10	100
0640CBSSX	M6 x 40	10	100
0650CBSSX	M6 x 50	10	100
0675CBSSX	M6 x 75	10	50
06100CBSSX	M6 x 100	10	50
0840CBSSX	M8 x 40	10	100
0850CBSSX	M8 x 50	5	100
0860CBSSX	M8 x 60	5	100
0875CBSSX	M8 x 75	5	100
0880CBSSX	M8 x 80	5	100
08100CBSSX	M8 x 100	5	50
08130CBSSX	M8 x 130	5	50
08150CBSSX	M8 x 150	5	50
1075CBSSX	M10 x 75	5	50
1090CBSSX	M10 x 90	5	50
10100CBSSX	M10 x 100	5	50
10110CBSSX	M10 x 110	5	50
10120CBSSX	M10 x 120	5	50
10130CBSSX	M10 x 130	5	50
10150CBSSX	M10 x 150	5	30
1275CBSSX	M12 x 75	5	50
12100CBSSX	M12 x 100	5	30
12110CBSSX	M12 x 110	5	30
12130CBSSX	M12 x 130	5	30

TYPE - SSB

SUB TYPE - SSB05

Carriage Bolt (DIN603) & Hex Nut (DIN934)

A2 Austenitic Stainless Steel

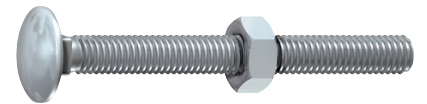

A cup square carriage bolt in A2 stainless steel. A full metric fine thread.

Product Code	Size (mm)	Nut Socket Size (mm)	Pack Qty (pcs)	Carton Qty (packs)
TIMPAC				
08100CBSSP	M8 x 100	13	4	5
08130CBSSP	M8 x 130	13	3	5
08150CBSSP	M8 x 150	17	2	5
1075CBSSP	M10 x 75	17	3	5
10100CBSSP	M10 x 100	17	2	5
10120CBSSP	M10 x 120	17	2	5
10130CBSSP	M10 x 130	17	2	5
10150CBSSP	M10 x 150	13	2	5
12100CBSSP	M12 x 100	19	2	5
12130CBSSP	M12 x 130	19	2	5

TYPE - PAK

SUB TYPE - PAK25