

# STELLA-FIX

## UNIVERSAL ANCHOR

**EASY INSTALLATION, JUST PUSH & FIX**

A highly effective universal anchor for fixing heavy loads to plasterboard, cavities and solid materials.

### TECHNICAL DATA

Substrate	Plasterboard 12.5mm Thickness	Dense board 15mm Thickness	Double board 25mm Thickness
Anchor Type	Red	Red	Black
Anchor Length (mm)	49	49	59
Drill Hole Ø (mm)	10	10	10
Rec. Tensile Load (kN)	0.33	0.41	0.48
Max Rec. Load (kg)	33	41	48

PERFECT FOR  
DOUBLE  
BOARD

PERFECT FOR  
SINGLE  
BOARD



### WEIGHTS & MATERIALS

33  
KG

DRYWALL /  
PLASTERBOARD

25mm Thickness

41  
KG

DENSE  
BOARD

25mm Thickness

Up To  
48  
KG

DOUBLE  
BOARD

15mm Thickness

### PERFECT FOR FITTING



TV Brackets



Radiators



Cabinets



Product Code	Screw Size (mm)	Plug Length (mm)	Board Thickness (mm)	MFT (mm)	Pack Qty (pcs)	Carton Qty (packs)	Pallet Qty (packs)
<b>BOX</b>							
<b>RED FIXING</b>							
STRED55	M5 x 55	49	3-18	15	25	20	1200
STRED80	M5 x 80	49	3-18	40	25	10	800
<b>BLACK FIXING</b>							
STBLACK65	M5 x 65	59	18-30	12	25	20	1200
STBLACK90	M5 x 90	59	18-30	38	25	10	800

MFT = MAX FIXTURE THICKNESS ANO04



Product Code	Screw Size (mm)	Plug Length (mm)	Board Thickness (mm)	MFT (mm)	Pack Qty (pcs)	Carton Qty (packs)
<b>PACK</b>						
<b>RED FIXING</b>						
725374	M5 x 55	49	3-18	15	4	5
725146	M5 x 80	49	3-18	40	4	5
<b>BLACK FIXING</b>						
725012	M5 x 65	59	18-30	12	4	5
725973	M5 x 90	59	18-30	38	4	5

MFT = MAX FIXTURE THICKNESS PAK45

**DRILL**



Drill a 10mm hole in the substrate.

**PUSH**

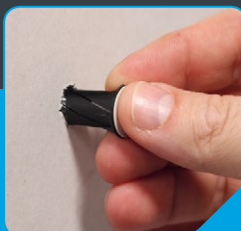

Push the Stella-Fix plug firmly into the hole.

**INSERT**



Insert the Stella-Fix screw through the fixing.

**FIX**



Tighten the screw until the fixing is secure.